

STANDARD FOR STABILIZATION WITH MULCH ONLY

1. **SITE PREPARATION**
 - A. GRADE AS NEEDED AND FEASIBLE TO PERMIT THE USE OF CONVENTIONAL EQUIPMENT FOR SEEDBED PREPARATION, SEEDING, MULCH APPLICATION, AND MULCH ANCHORING. ALL GRADING SHOULD BE DONE IN ACCORDANCE WITH STANDARDS FOR LAND GRADING.
 - B. INSTALL NEEDED EROSION CONTROL PRACTICES OR FACILITIES SUCH AS DIVERSIONS, GRADE STABILIZATION STRUCTURES, CHANNEL STABILIZATION MEASURES, SEDIMENT BASINS, AND WATERWAYS. SEE STANDARDS 11-42.
2. **PROTECTIVE MATERIALS**
 - A. UNROTTED SMALL-GRAIN STRAW AT 2.0 TO 2.5 TONS PER ACRE IS SPREAD UNIFORMLY AT 90-115 POUNDS PER 1,000 S.F. AND ANCHORED WITH A MULCH ANCHORING TOOL, LIQUID MULCH BINDERS, OR NETTING THE DOWN. THE APPROVED RATED ABOVE HAVE BEEN MET WHEN THE MULCH COVERS THE GROUND COMPLETELY UPON VISUAL INSPECTION, I.E. THE SOIL CANNOT BE SEEN BELOW THE MULCH.
 - C. SYNTHETIC OR ORGANIC SOIL STABILIZERS MAY BE USED UNDER SUITABLE CONDITIONS AND IN QUANTITIES AS RECOMMENDED BY THE MANUFACTURER.
 - D. WOOD-FIBER OR PAPER-FIBERMULCH AT THE RATE OF 1,500 POUNDS PER ACRE (OR ACCORDING TO THE MANUFACTURER'S REQUIREMENTS) MAY BE APPLIED BY A HYDROSEEDER.
 - E. MULCH NETTING, SUCH AS PAPER JUTE, EXCELSIOR, COTTON, OR PLASTIC, MAY BE USED.
 - F. WOODCHIPS APPLIED UNIFORMLY TO A MINIMUM DEPTH OF 2 INCHES MAY BE USED. WOODCHIPS WILL NOT BE USED ON AREAS WHERE FLOWING WATER COULD WASH THEM INTO AN INLET AND PLUG IT.
 - G. GRAVEL, CRUSHED STONE, OR SLAG AT THE RATE OF 9 CUBIC YARDS PER 1,000 S.F. APPLIED UNIFORMLY TO A MINIMUM DEPTH OF 3 INCHES MAY BE USED. SIZE 2 OR 3 (ASTM C-33) IS RECOMMENDED.
3. **MULCH ANCHORING**

MULCH ANCHORING SHOULD BE ACCOMPLISHED IMMEDIATELY AFTER PLACEMENT OF HAY OR STRAW MULCH TO MINIMIZE LOSS BY WIND OR WATER. THIS MAY BE DONE BY ONE OR THE FOLLOWING METHODS, DEPENDING UPON THE SIZE OF THE AREA AND STEEPNESS OF SLOPES.

 - A. PEG AND TWINE - DRIVE 8 TO 10 INCH WOODEN PEGS TO WITHIN 2-3 INCHES OF THE SOIL SURFACE EVERY 4 FEET IN ALL DIRECTIONS. STAKES MAY BE DRIVEN BEFORE OR AFTER APPLYING MULCH. SECURE MULCH TO SOIL SURFACE BY STRETCHING TWINE BETWEEN PEGS IN A CRISSCROSS AND A SQUARE PATTERN. SECURE TWINE AROUND EACH PEG WITH TWO OR MORE ROUND TURNS.
 - B. MULCH NETTINGS - STAPLE PAPER, COTTON, OR PLASTIC NETTINGS OVER MULCH. USE DEGRADABLE NETTING IN AREAS TO BE MOWED. NETTING IS USUALLY AVAILABLE IN ROLLS 4 FEET WIDE AND UP TO 300 FEET LONG.
 - C. CRIMPER MULCH ANCHORING COULTER TOOL - A TRACTOR DRAWN IMPLEMENT ESPECIALLY DESIGNED TO PUNCH AND ANCHOR MULCH INTO THE SOILD SURFACE. THIS PRACTICE AFFORDS MAXIMUM EROSION CONTROL, BUT ITS USE IS LIMITED TO THOSE SLOPES UPON WHICH THE TRACTOR CAN OPERATE SAFELY. SOIL PENETRATION SHOULD BE ABOUT 3 TO 4 INCHES. ON SLOPING LAND, THE OPERATION SHOULD BE ON THE CONTOUR.
 - D. LIQUID MULCH-BINDERS
 1. APPLICATIONS SHOULD BE HEAVIER AT EDGES WHERE WIND CATCHES THE MULCH, IN VALLEYS, AND AT CRESTS OF BANKS. REMAINDER OF AREA SHOULD BE UNIFORM IN APPEARANCE.
 2. USE ONE OF THE FOLLOWING:
 - a. ORGANIC AND VEGETABLE BASED BINDERS - NATURALLY OCCURRING, POWDER BASED, HYDROPHILIC MATERIALS THAT MIXED WITH WATER FORMULATES A GEL AND WHEN APPLIED TO MULCH UNDER SATISFACTORY CURING CONDITIONS WILL FORM MEMBRANED NETWORKS OF INSOLUBLE POLYMERS. THE VEGETABLE GEL SHALL BE PHYSIOLOGICALLY HARMLESS AND NOT RESULT IN A PHYTOTOXIC EFFECT OR IMPIDE GROWTH OF TURFGRASS. VEGETABLE BASED GELS SHALL BE APPLIED AT RATES AND WEATHER CONDITIONS RECOMMENDED BY THE MANUFACTURER.
 - b. SYNTHETIC BINDERS - HIGH POLYMER SYNTHETIC EMULSION, MISCIBLE WITH WATER WHEN DILUTED AND FOLLOWING APPLICATION TO MULCH, DRYING AND CURING SHALL NO LONGER BE SOLUBLE OR DISPERSIBLE IN WATER. IT SHALL BE APPLIED AT RATES AND WEATHER CONDITIONS RECOMMENDED BY THE MANUFACTURER AND REMAIN TACKY UNTIL GERMINATION OF GRASS.

NOTE: MULCHING IS REQUIRED ON ALL SEEDING

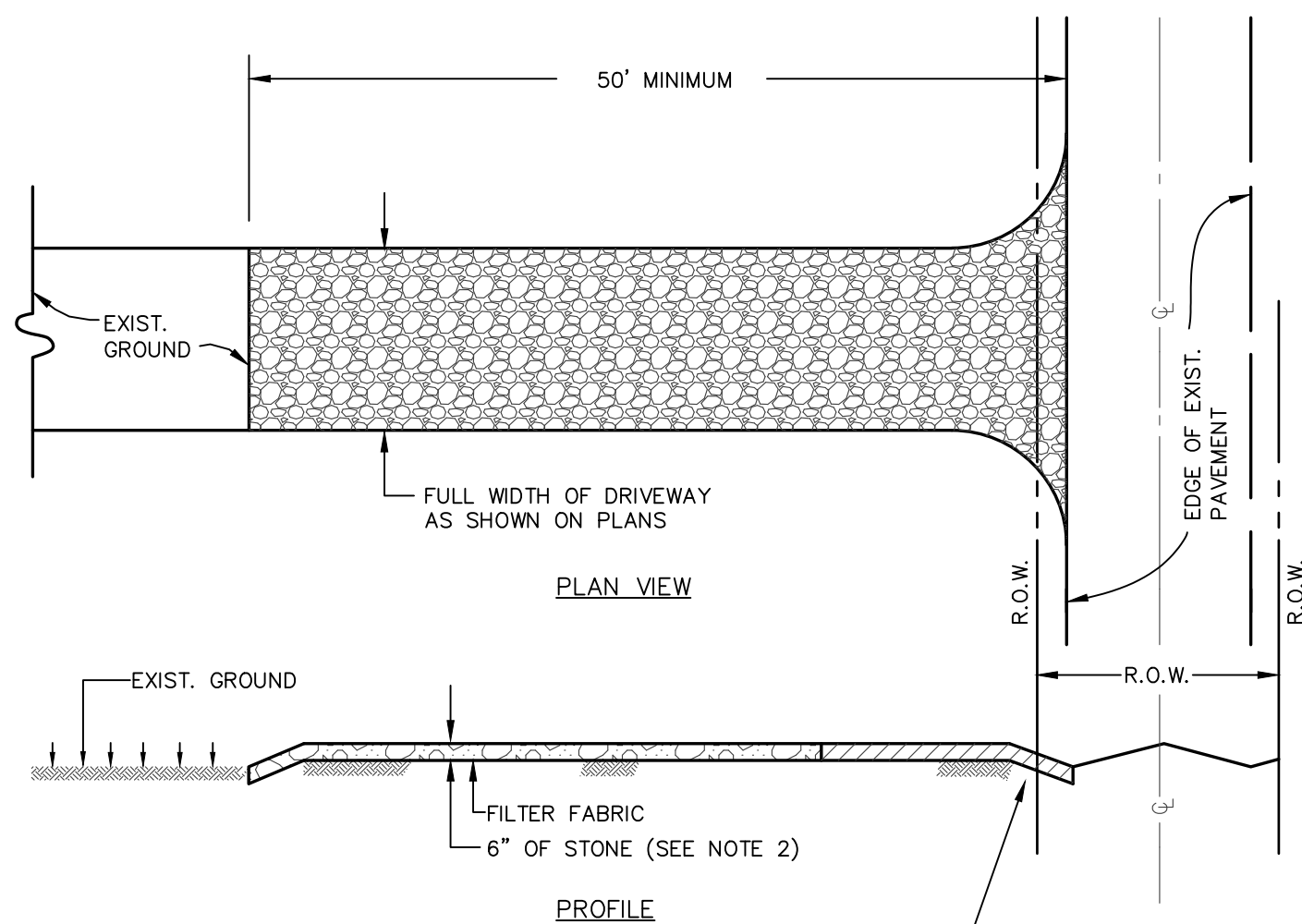

NOTES:

1. PLACE STABILIZED CONSTRUCTION ENTRANCE AT LOCATION(S) AS SHOWN ON THE SOIL EROSION AND SEDIMENT CONTROL PLAN.
2. STONE SIZE SHALL BE ASTM C-33, SIZE NO.2 OR 3, CRUSHED STONE.
3. THE THICKNESS OF THE STAB. CONST. ENT. SHALL NOT BE LESS THAN 6".
4. THE WIDTH AT THE EXIST. PAVEMENT SHALL NOT BE LESS THAN THE FULL WIDTH OF POINTS OF INGRESS AND EGRESS.
5. THE STAB. CONST. ENT. SHALL BE MAINTAINED IN A CONDITION WHICH WILL PREVENT TRACKING OR FLOWING OF SEDIMENT ONTO THE R.O.W./PAVEMENT. THIS REQUIRES PERIODIC TOP DRESSING WITH ADDITIONAL STONE OR ADDITIONAL LENGTH AS CONDITIONS DEMAND AND REPAIR AND/OR CLEANOUT OF ANY MEASURE USED TO TRAP SEDIMENT.
6. ALL SEDIMENT SPILLED, DROPPED, WASHED, OR TRACKED ONTO THE PUBLIC ROADWAY MUST BE REMOVED IMMEDIATELY.

STABILIZED CONSTRUCTION ENTRANCE

N.T.S.

SEEDING SCHEDULE

1. GRADE AS NEEDED AND FEASIBLE TO PERMIT THE USE OF CONVENTIONAL EQUIPMENT FOR SEED BED PREPARATION, SEEDING AND MULCH APPLICATION.
2. TEMPORARY SEEDING SHALL CONSIST OF EITHER:

COOL SEASON GRASSES	RATES	SEEDING DATES	
PERENNIAL RYEGRASS	1.0 LBS./S.F.	3/1-5/15 OR 8/15-10/1	0.5 IN.
SPRING OASTS	2.0 LBS./S.F.	3/1-5/15 OR 8/15-10/1	1.0 IN.
WINTER BARLEY	2.2 LBS./S.F.	8/15-10/1	1.0 IN.
WINTER CEREAL RYE	2.8 LBS./S.F.	8/1-11/15	DEPTHS 1.0 IN.
WARM SEASON GRASSES			
PEARL MILLET	0.5 LBS./S.F.	5/15-8/15	1.0 IN.
MILLET (GERMAN OR HUNGARIAN)	0.7 LBS./S.F.	5/15-8/15	1.0 IN.
3. ANY DISTURBED AREAS THAT WILL BE LEFT EXPOSED MORE THAN THIRTY (30) DAYS, AND NOT SUBJECT TO CONSTRUCTION TRAFFIC, WILL IMMEDIATELY RECEIVE A TEMPORARY SEEDING. IF THE SEASON PREVENTS THE ESTABLISHMENT OF A TEMPORARY COVER, THE DISTURBED AREAS WILL BE MULCHED WITH UNROTTED SMALL GRAIN STRAW, HAY FREE OF SEEDS, OR SALT HAY TO BE APPLIED AT THE RATE OF 1-1/2 TO 2 TONS PER ACRE (70 TO 90 LBS. PER 1,000 S.F.), EXCEPT WHERE A CRIMPER IS USED INSTEAD OF A LIQUID MULCH-BINDER (TACKIFYING OR ADHESIVE AGENT), THE RATE OF APPLICATION IS 3 TONS PER ACRE. MULCH CHOPPER-BLOWERS MUST NOT GRIND THE MULCH.
4. SEEDBED PREPARATION
 - A. UNIFORMLY APPLY GROUND LIMESTONE AND FERTILIZER TO TOPSOIL WHICH HAS BEEN SPREAD AND FIRMED, ACCORDING TO SOIL TEST RECOMMENDATIONS SUCH AS OFFERED BY RUTGERS CO-OPERATIVE EXTENSION. SOIL SAMPLE MAILERS ARE AVAILABLE FROM THE LOCAL RUTGERS COOPERATIVE EXTENSIONS OFFICES (HTTP://NJAES.RUTGERS.EDU/COUNTY/). FERTILIZER SHALL BE APPLIED AT A RATE OF 500 POUNDS PER ACRE OR 11 POUNDS PER 1,000 SQUARE FEET OF 10-10-10 OR EQUIVALENT WITH 50% WATER INSOLUBLE NITROGEN UNLESS A SOIL TEST INDICATES OTHERWISE AND INCORPORATED INTO THE SURFACE 4 INCHES. IF FERTILIZER IS NOT INCORPORATED, APPLY ONE-HALF THE RATE DESCRIBED ABOVE DURING SEEDBED PREPARATION AND REPEAT ANOTHER ONE-HALF RATE APPLICATION OF THE SAME FERTILIZER WITHIN 3 TO 5 WEEKS AFTER SEEDING.
 - B. WORK LIME AND FERTILIZER INTO THE TOPSOIL AS NEARLY AS PRACTICABLE TO A DEPTH OF 4 INCHES WITH A DISC, SPRING-TOOTH HARROW, OR OTHER SUITABLE EQUIPMENT. THE FINAL HARROWING OR DISKING OPERATION SHOULD BE ON THE GENERAL CONTOUR. CONTINUE TILLAGE UNTIL A REASONABLE UNIFORM SEEDBED IS PREPARED.
 - C. HIGH ACID PRODUCING SOILS. SOILS HAVING A PH OF 4 OR LESS OR CONTAINING IRON SULFIDE SHALL BE COVERED WITH A MINIMUM OF 12 INCHES OF SOIL HAVING A PH OF 5 OR MORE BEFORE INITIATING SEEDBED PREPARATION. SEE STANDARD FOR MANAGEMENT OF HIGH ACID-PRODUCING SOILS FOR SPECIFIC REQUIREMENTS.
5. REMOVE FROM THE SURFACE ALL STONES TWO INCHES OR LARGER IN ANY DIMENSION, REMOVE ALL OTHER DEBRIS, SUCH AS WIRE, CABLE, TREE ROOTS, PIECES OF CONCRETE, LUMPS OR ANY OTHER UNSUITABLE MATERIAL.
6. PERMANENT GROUND COVER OF SODDING OR SEEDING SHALL CONSIST OF THE FOLLOWING MIXTURE OR APPROVED EQUAL:

SEEDING	RATES
TALL FESCUE	6.0 LBS./1,000 S.F.
KENTUCKY BLUEGRASS (BLEND)	0.5 LBS./1,000 S.F.
PERENNIAL RYEGRASS (BLEND)	0.5 LBS./1,000 S.F.

OPTIMAL SEEDING DATES: 3/1-4/30 AND 8/15-11/15
ACCEPTABLE SEEDING DATES: 5/1-8/14
SEED TO A DEPTH OF 0.5 IN.
7. THE SEEDING SHOULD BE FIRMED FOLLOWING SEEDING OPERATIONS WITH A ROLLER OR LIGHT DRAG.
8. TACKING SHALL BE PERFORMED AS PER THE CURRENT STANDARDS OF THE FREEHOLD SOIL CONSERVATION DISTRICT. ASPHALT TACKIFIERS ARE NOT ACCEPTABLE.

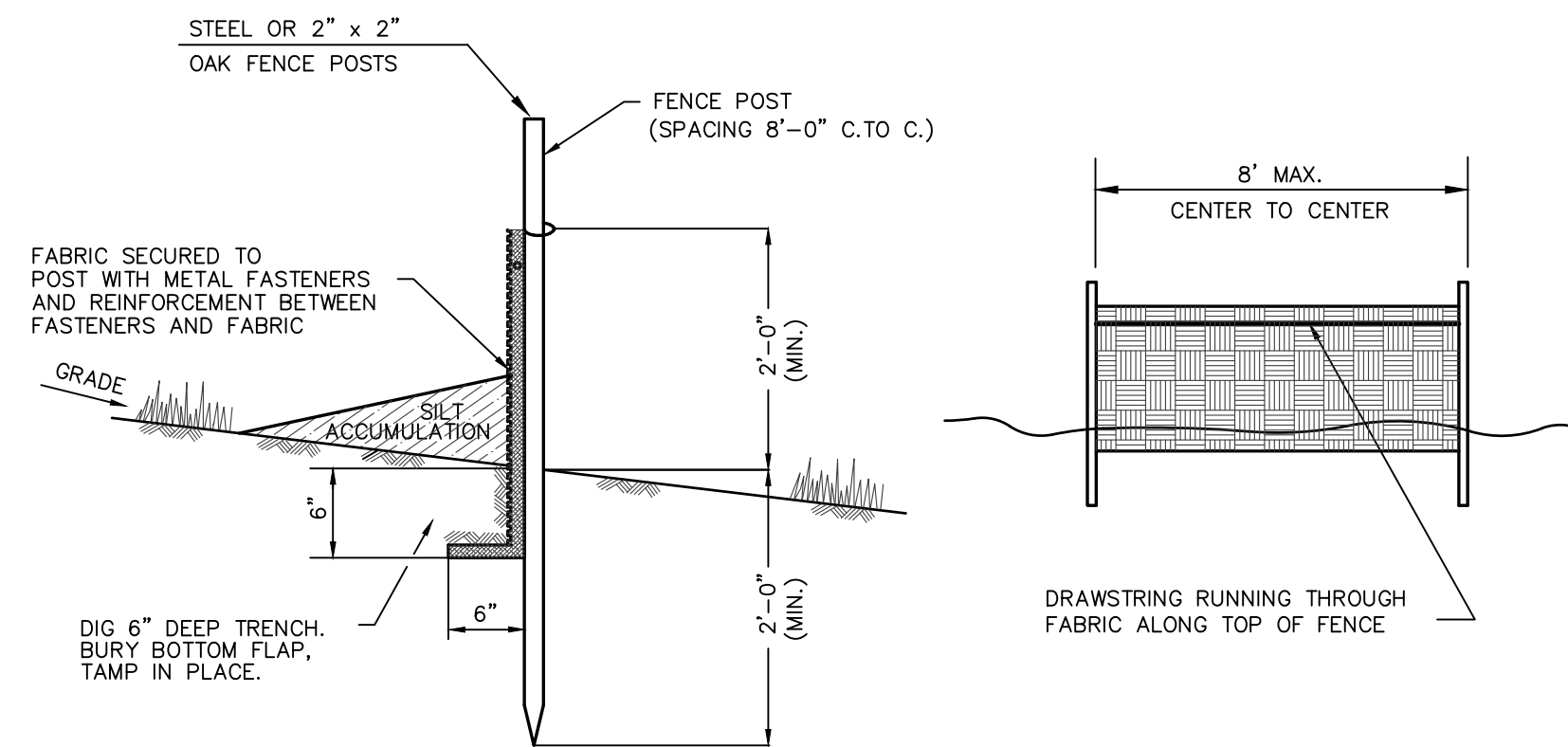

NOTE: SYNTHETIC FILTER FABRIC SHALL BE FIRMLY ATTACHED TO UPHILL SIDE OF FENCE POSTS. OPEN AREA SHALL BE GREATER THAN 4% BUT LESS THAN 10% MEETING U.S. ARMY CORPS. OF ENGINEERS SPECIFICATION NO. CW02215 FOR STRENGTH.

SILT FENCE DETAIL
N.T.S.

CONSTRUCTION SCHEDULE AND PROCEDURE FOR IMPLEMENTATION OF SOIL EROSION AND SEDIMENT CONTROL MEASURES

- | | |
|--|--------------|
| 1. INSTALL SILT FENCE. | 1 DAY |
| 2. PROVIDE TEMPORARY ACCESS PROTECTION (CONSTRUCTION ENTRANCE). | 1 DAY |
| 3. DEMOLISH EXISTING STRUCTURES AND REMOVE EXISTING PAVEMENT. | 2 WEEKS |
| 4. STRIP TOPSOIL. APPLY TEMPORARY STABILIZATION. | 2 DAYS |
| 5. ESTABLISH ROUGH GRADES AS NECESSARY TO CONSTRUCT BUILDING. | 2 DAYS |
| 6. CONSTRUCT BUILDING AND SITE IMPROVEMENTS. | 18-24 MONTHS |
| 7. CONSTRUCT FINE GRADING TO FINISHED GRADES, RE-SPREAD TOPSOIL AND ESTABLISH PERMANENT VEGETATIVE COVER ON THE LOT. | 1 WEEK |
| 8. REMOVE ACCESS PROTECTION, INLET PROTECTION, AND SILT FENCE AFTER ALL DISTURBED AREAS HAVE BEEN STABILIZED. | 1 DAY |

SOIL EROSION AND SEDIMENT CONTROL NOTES

1. THE FREEHOLD SOIL CONSERVATION DISTRICT SHALL BE NOTIFIED FORTY-EIGHT (48) HOURS IN ADVANCE OF ANY LAND DISTURBING ACTIVITY.
2. ALL SOIL EROSION AND SEDIMENT CONTROL PRACTICES ARE TO BE INSTALLED PRIOR TO SOIL DISTURBANCE, OR IN THEIR PROPER SEQUENCE, AND MAINTAINED UNTIL PERMANENT PROTECTION IS ESTABLISHED.
3. ANY CHANGES TO THE CERTIFIED SOIL EROSION AND SEDIMENT CONTROL PLANS WILL REQUIRE THE SUBMISSION OF REVISED SOIL EROSION AND SEDIMENT CONTROL PLANS TO THE DISTRICT FOR RECERTIFICATION. THE REVISED PLANS MUST MEET ALL CURRENT STATE SOIL EROSION AND SEDIMENT CONTROL STANDARDS.
4. N.J.S.A. 4:24-39 ET. SEQ. REQUIRES THAT NO CERTIFICATE OF OCCUPANCY BE ISSUED BEFORE THE DISTRICT DETERMINES THAT A PROJECT OR PORTION THEREOF IS IN FULL COMPLIANCE WITH THE CERTIFIED PLAN AND STANDARDS FOR SOIL EROSION AND SEDIMENT CONTROL IN NEW JERSEY AND A REPORT OF COMPLIANCE HAS BEEN ISSUED. UPON WRITTEN REQUEST FROM THE APPLICANT, THE DISTRICT MAY ISSUE A REPORT OF COMPLIANCE WITH CONDITIONS ON A LOT BY LOT OR SECTION BY SECTION BASIS, PROVIDED THAT THE PROJECT OR PORTION THEREOF IS IN SATISFACTORY COMPLIANCE WITH THE SEQUENCE OF DEVELOPMENT AND TEMPORARY MEASURES FOR SOIL EROSION AND SEDIMENT CONTROL HAVE BEEN IMPLEMENTED, INCLUDING PROVISIONS FOR STABILIZATION AND SITE WORK.
5. ANY DISTURBED AREAS THAT WILL BE LEFT EXPOSED FOR MORE THAN SIXTY (60) DAYS, AND NOT SUBJECT TO CONSTRUCTION TRAFFIC, WILL IMMEDIATELY RECEIVE TEMPORARY SEEDING. IF THE SEASON PREVENTS THE ESTABLISHMENT OF TEMPORARY COVER, THE DISTURBED AREAS WILL BE MULCHED WITH STRAW OR EQUIVALENT MATERIAL, AT A RATE OF 2-2 1/2 TONS PER ACRE, ACCORDING TO THE STANDARD FOR STABILIZATION WITH MULCH ONLY.
6. IMMEDIATELY FOLLOWING INITIAL DISTURBANCE OR ROUGH GRADING, ALL CRITICAL AREAS SUBJECT TO EROSION (I.E. SOIL STOCKPILES, STEEP SLOPES AND ROADWAY EMBANKMENTS) WILL RECEIVE TEMPORARY SEEDING IN COMBINATION WITH STRAW MULCH OR A SUITABLE EQUIVALENT, AND A MULCH ANCHOR, IN ACCORDANCE WITH STATE STANDARDS.
7. A SUB-BASE COURSE WILL BE APPLIED IMMEDIATELY FOLLOWING ROUGH GRADING AND INSTALLATION OF IMPROVEMENTS TO STABILIZE STREETS, ROADS, DRIVEWAYS, AND PARKING AREAS IN AREAS WHERE NO UTILITIES ARE PRESENT, THE SUB-BASE SHALL BE INSTALLED WITHIN FIFTEEN (15) DAYS OF PRELIMINARY GRADING.
8. THE STANDARD FOR STABILIZED CONSTRUCTION ACCESS REQUIRES THE INSTALLATION OF A PAD OF CLEAN CRUSHED STONE AT POINTS WHERE TRAFFIC WILL BE ACCESSING THE CONSTRUCTION SITE. AFTER INTERIOR ROADWAYS ARE PAVED, INDIVIDUAL LOTS REQUIRE A STABILIZED CONSTRUCTION ACCESS CONSISTING OF 1" - 2" STONE FOR A MINIMUM LENGTH OF 10' EQUAL TO THE LOT ENTRANCE WIDTH. ALL OTHER ACCESS POINTS SHALL BE BLOCKED OFF.
9. ALL SOIL WASHED, DROPPED, SPILLED OR TRACKED OUTSIDE THE LIMIT OF DISTURBANCE OR ONTO THE PUBLIC RIGHT-OF-WAYS WILL BE REMOVED IMMEDIATELY.
10. PERMANENT VEGETATION IS TO BE SEEDED OR SODDED ON ALL EXPOSED AREAS WITHIN TEN (10) DAYS AFTER FINAL GRADING.
11. AT THE TIME THAT SITE PREPARATION FOR PERMANENT VEGETATIVE STABILIZATION IS GOING TO BE ACCOMPLISHED, ANY SOIL THAT WILL NOT PROVIDE A SUITABLE ENVIRONMENT TO SUPPORT ADEQUATE VEGETATIVE GROUND COVER SHALL BE REMOVED OR TREATED IN SUCH A WAY THAT IT WILL PERMANENTLY ADJUST THE SOIL CONDITIONS AND RENDER IT SUITABLE FOR VEGETATIVE GROUND COVER. IF THE REMOVAL OR TREATMENT OF THE SOIL WILL NOT PROVIDE SUITABLE CONDITIONS, NON-VEGETATIVE MEANS OF PERMANENT GROUND STABILIZATION WILL HAVE TO BE EMPLOYED.
12. IN ACCORDANCE WITH THE STANDARD FOR MANAGEMENT OF HIGH ACID PRODUCING SOILS, ANY SOIL HAVING A PH OF 4 OR LESS OR CONTAINING IRON SULFIDES SHALL BE ULTIMATELY PLACED OR BURIED WITH LIMESTONE APPLIED AT THE RATE OF 10 TONS / ACRE, (OR 450 LBS / 1000 SF OF SURFACE AREA) AND COVERED WITH A MINIMUM OF 12" OF SETTLED SOIL WITH A PH OF 5 OR MORE, OR 24" WHERE TREES OR SHRUBS ARE TO BE PLANTED.
13. CONDUIT OUTLET PROTECTION MUST BE INSTALLED AT ALL REQUIRED OUTFALLS PRIOR TO THE DRAINAGE SYSTEM BECOMING OPERATIONAL.
14. UNFILTERED DEWATERING IS NOT PERMITTED. NECESSARY PRECAUTIONS MUST BE TAKEN DURING ALL DEWATERING OPERATIONS TO MINIMIZE SEDIMENT TRANSFER. ANY DEWATERING METHODS USED MUST BE IN ACCORDANCE WITH STANDARD FOR DEWATERING.
15. SHOULD THE CONTROL OF DUST AT THE SITE BE NECESSARY, THE SITE WILL BE SPRINKLED UNTIL THE SURFACE IS WET. TEMPORARY VEGETATIVE COVER SHALL BE ESTABLISHED OR MULCH SHALL BE APPLIED AS REQUIRED BY THE STANDARD FOR DUST CONTROL.
16. STOCKPILE AND STAGING LOCATIONS ESTABLISHED IN THE FIELD SHALL BE PLACED WITHIN THE LIMIT OF DISTURBANCE ACCORDING TO THE CERTIFIED PLAN. STAGING AND STOCKPILES NOT LOCATED WITHIN THE LIMIT OF DISTURBANCE WILL REQUIRE CERTIFICATION OF A REVISED SOIL EROSION AND SEDIMENT CONTROL PLAN. CERTIFICATION OF A NEW SOIL EROSION AND SEDIMENT CONTROL PLAN MAY BE REQUIRED FOR THESE ACTIVITIES IF AN AREA GREATER THAN 5,000 SQUARE FEET IS DISTURBED.
17. ALL SOIL STOCKPILES ARE TO BE TEMPORARILY STABILIZED IN ACCORDANCE WITH SOIL EROSION AND SEDIMENT CONTROL NOTE #6.
18. THE PROPERTY OWNER SHALL BE RESPONSIBLE FOR ANY EROSION OR SEDIMENTATION THAT MAY OCCUR BELOW STORM WATER OUTFALLS OR OFF SITE AS A RESULT OF CONSTRUCTION OF THE PROJECT.

COPYRIGHT © 2020, TWO RIVER ENGINEERING - ALL RIGHTS RESERVED. THE SOFTWARE, DRAWINGS, AND SERVICES ARE THE PROPERTY OF TWO RIVER ENGINEERING, INCORPORATED.

	04-08-2021	REVISED PER ENGINEERS LETTER DATED 2-4-21.
	10-1-2020	REVISED FOR COMPLETENESS
REV.	DATE	DESCRIPTION
<ul style="list-style-type: none"> ■ Civil Engineers ■ Forensic Experts ■ Environmental Consultants 		
		PROJECT NO.: 19079 DATE: APRIL 8, 2020 DRAWING NO.: 19079-01A DRAWN BY: AJG CLIENT: PARK VALLEY SCALE: N/A
P.O. Box 155 Colts Neck, N.J. 07722		Tel: 732.866.0111 Fax: 732.866.4348
SOIL EROSION AND SEDIMENT CONTROL PLAN "PARK VALLEY DEVELOPMENT" PRELIMINARY & FINAL MAJOR SITE PLAN OF BLOCK 33 LOT 9.01 TAX MAP SHEET NO. 2 BOROUGH OF RED BANK MONMOUTH COUNTY NEW JERSEY		
		 A.J. GARITO, JR. DATE: 04-08-21 N.J. Professional Engineer License No. 24GE03799700
		SHEET NO. 7 OF 8